

FUEL FILTER

AUXILIARY AIR VALVE

COLD START INJECTOR

INJECTOR

to the fuel tank

FUEL DISTRIBUTOR  
1976-1977

CONTROL PRESSURE REGULATOR

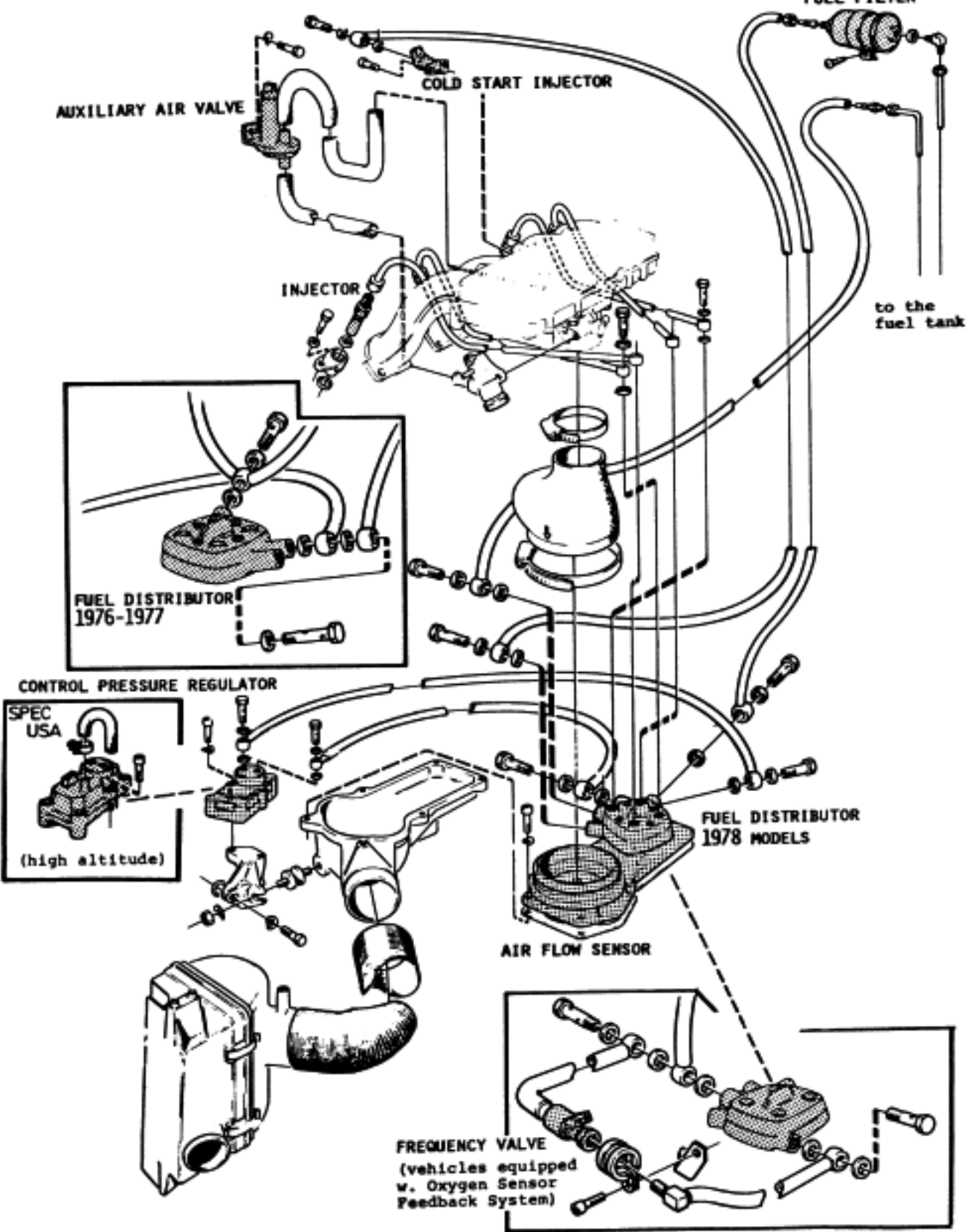
SPEC USA

(high altitude)

FUEL DISTRIBUTOR  
1978 MODELS

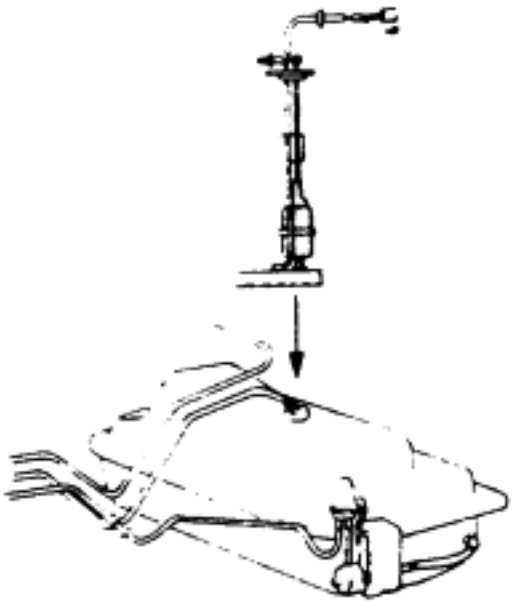
AIR FLOW SENSOR

FREQUENCY VALVE  
(vehicles equipped  
w. Oxygen Sensor  
Feedback System)



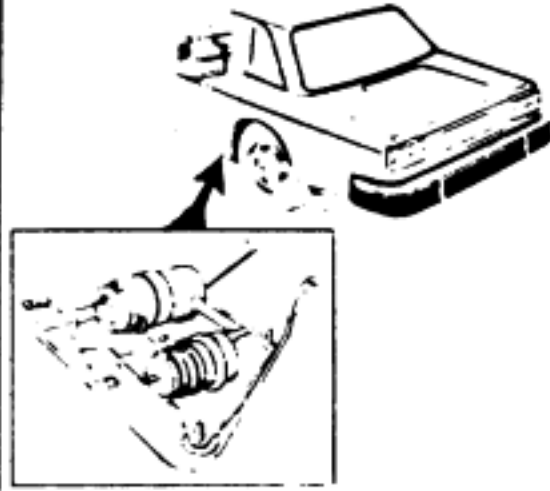


Tank pump

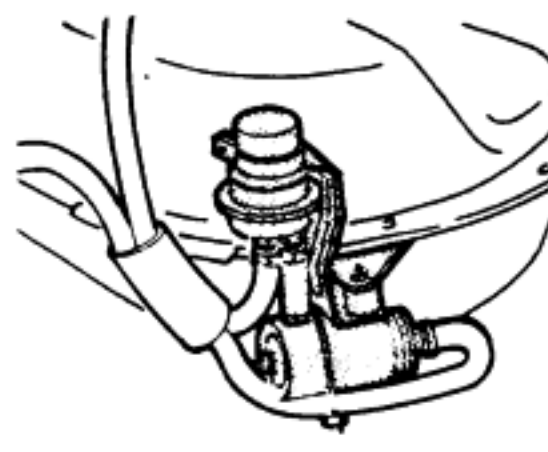


Fuel pump, fuel accumulator

1978 -

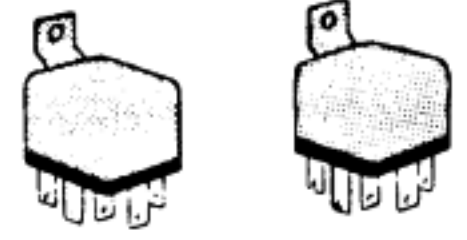


1975-1977

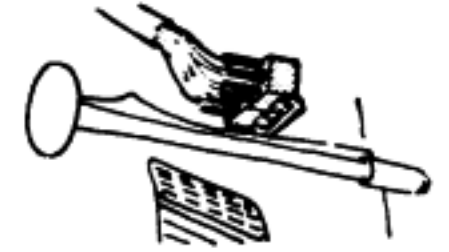


Relays

1975

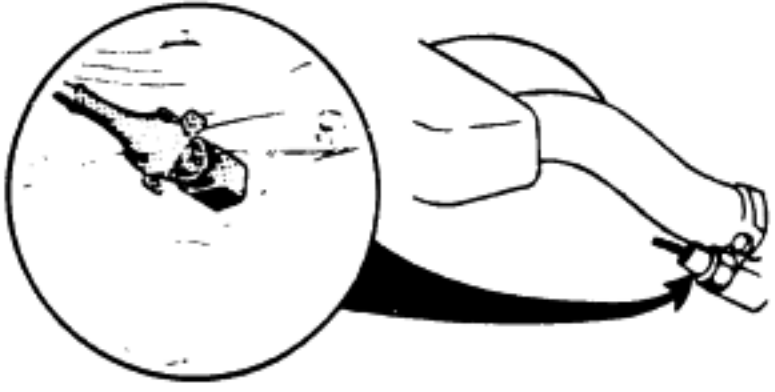


1976 -

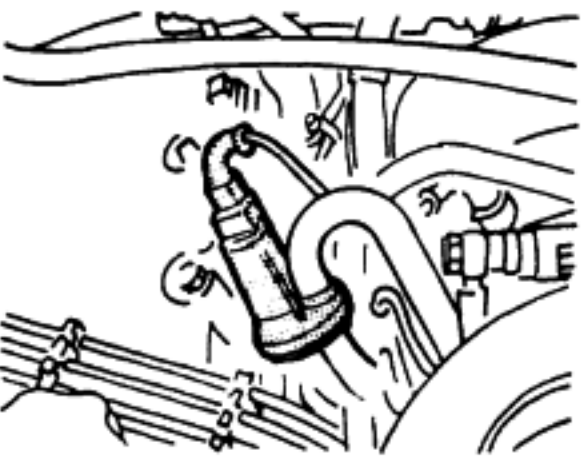


Transistorized relays introduced in 1978

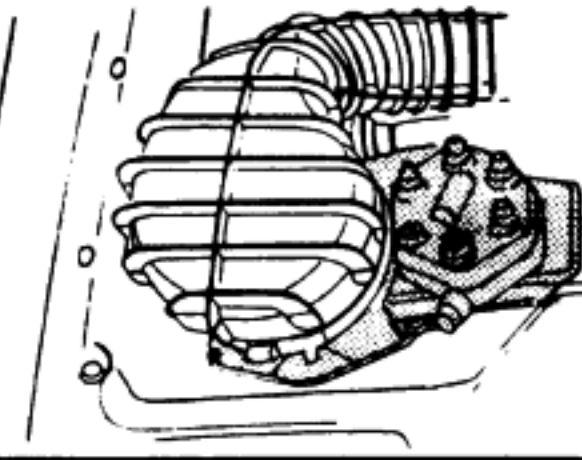
Thermal time switch



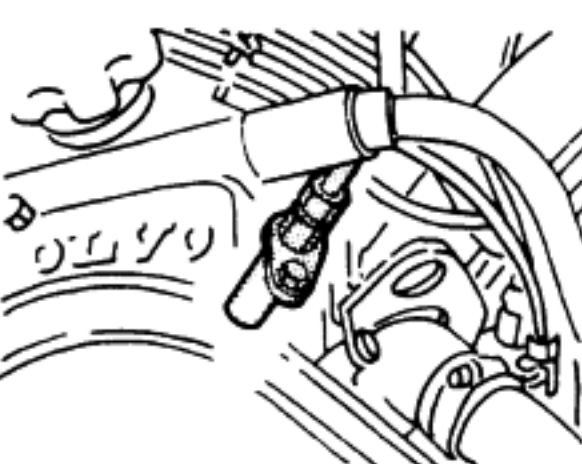
Auxiliary air valve



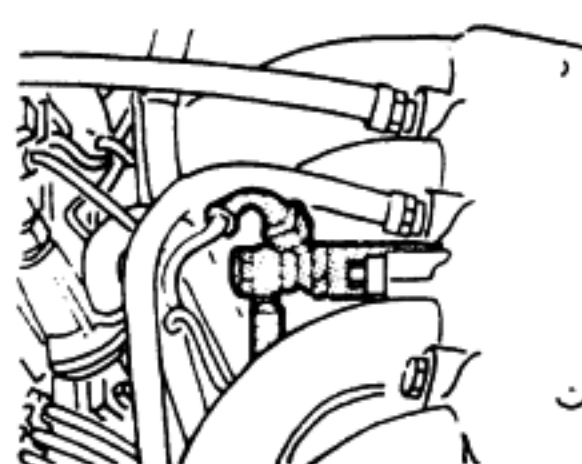
Air - fuel control unit, turbo



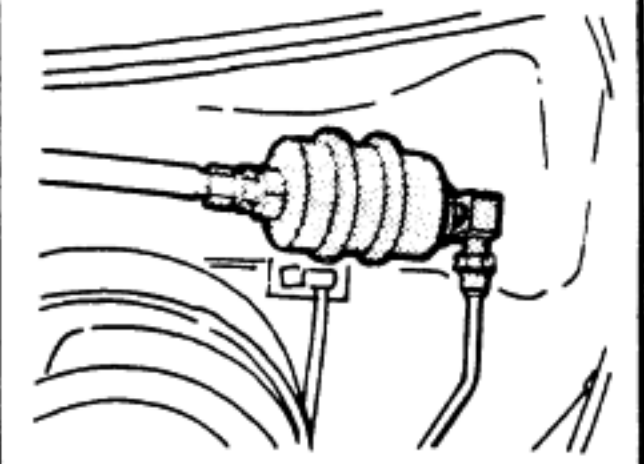
Injector



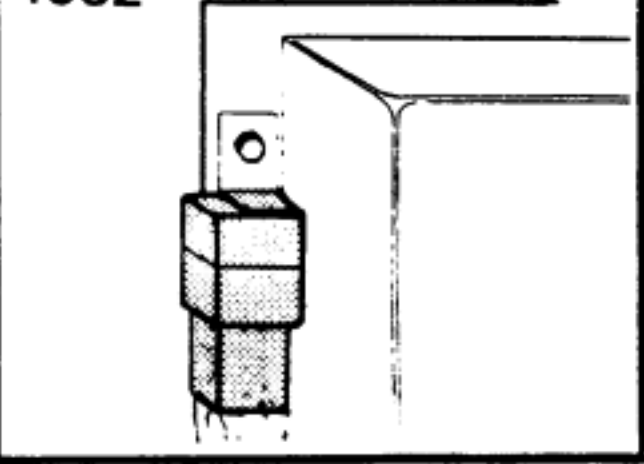
Start injector



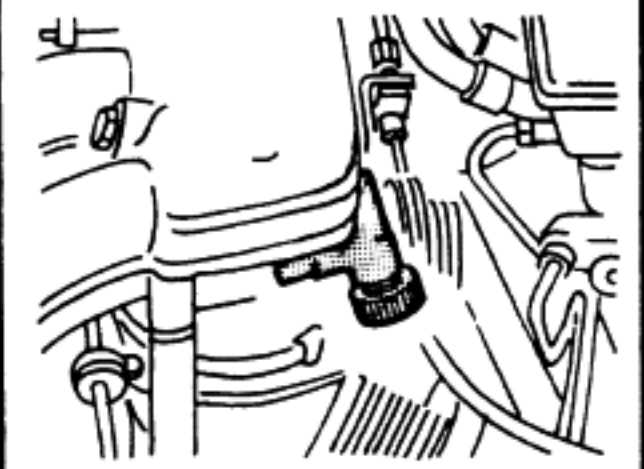
Fuel filter



Impulse relay, turbo  
1982 -



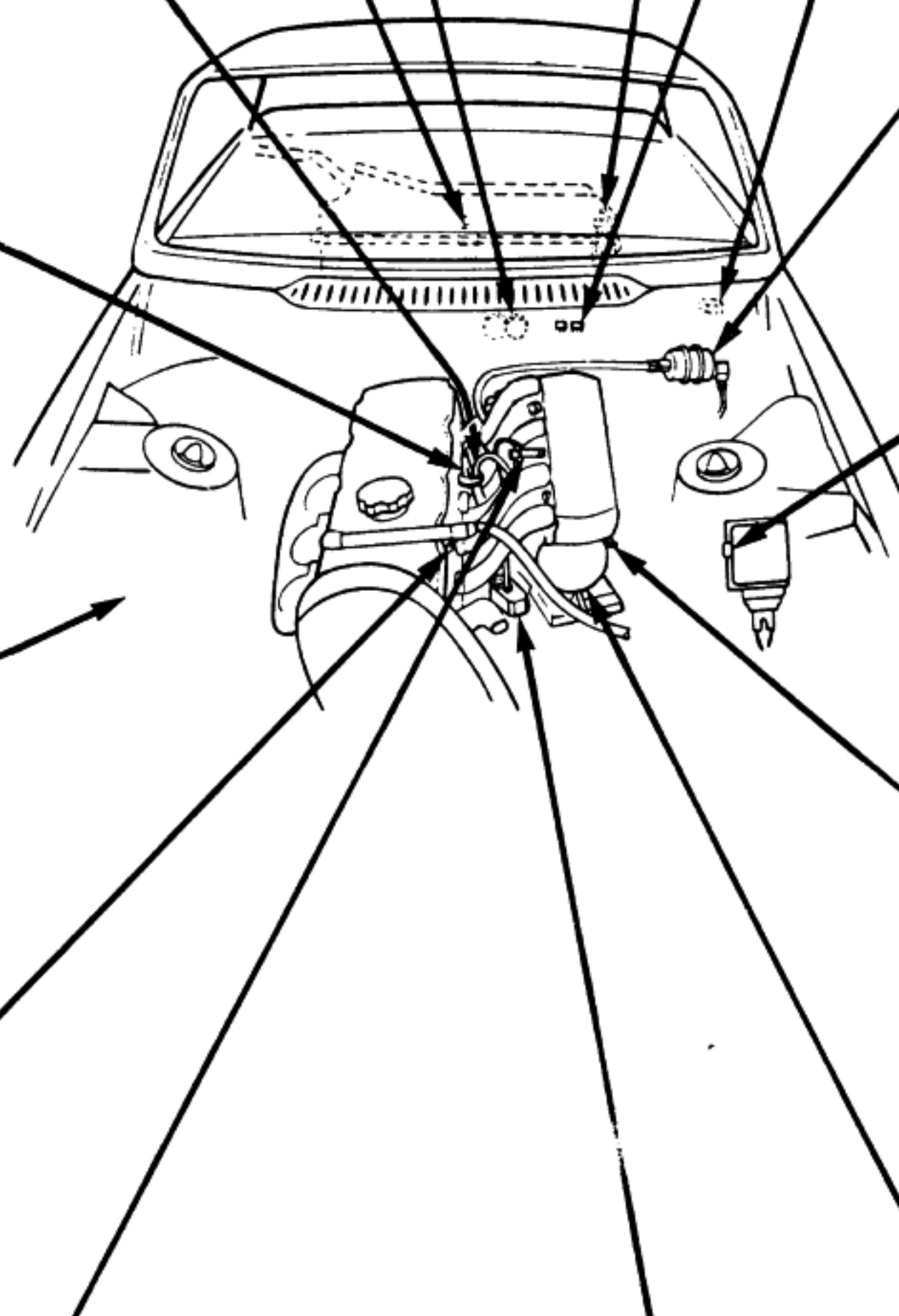
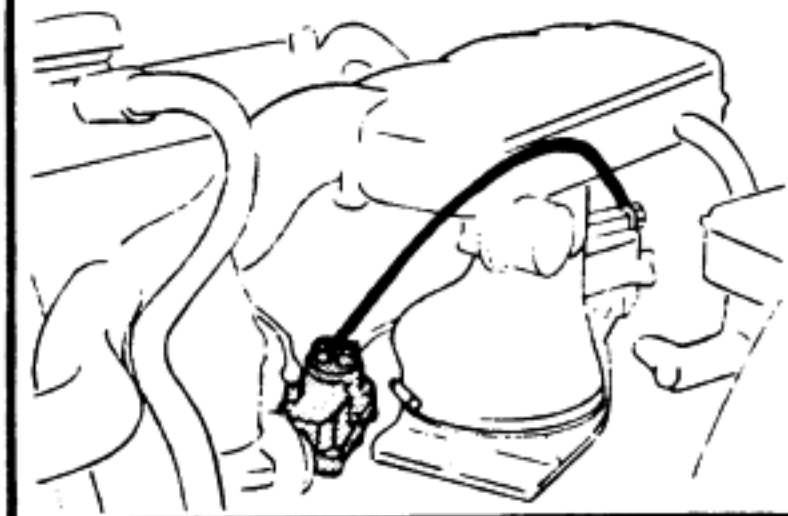
Idle adjustment screw

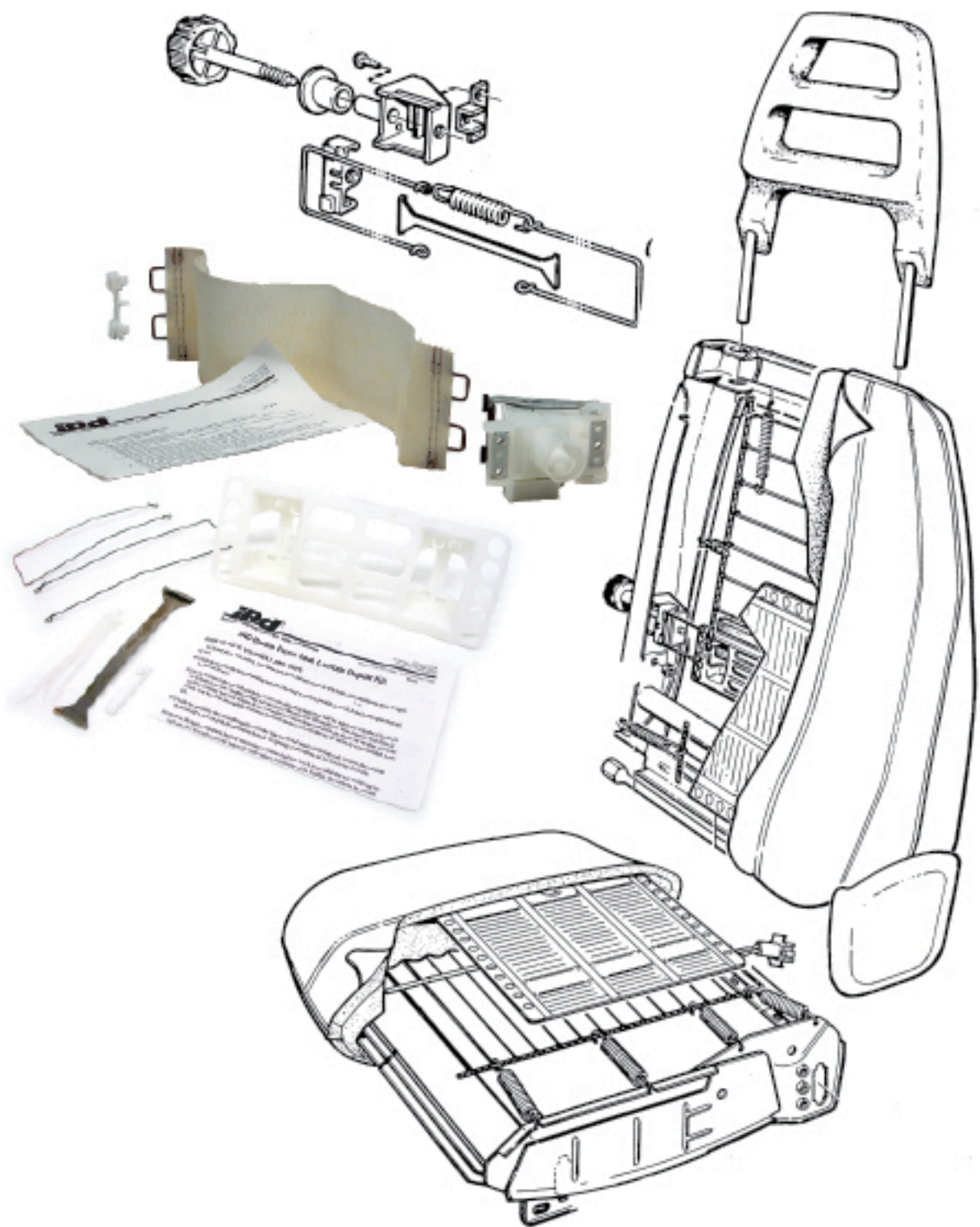


Air-fuel control unit



Control pressure regulator



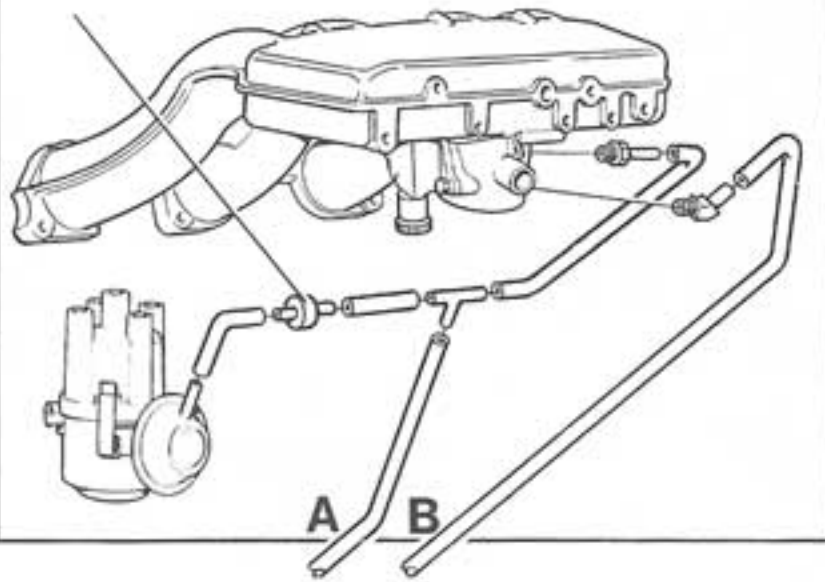


# Connection of carbon filter and EGR valve

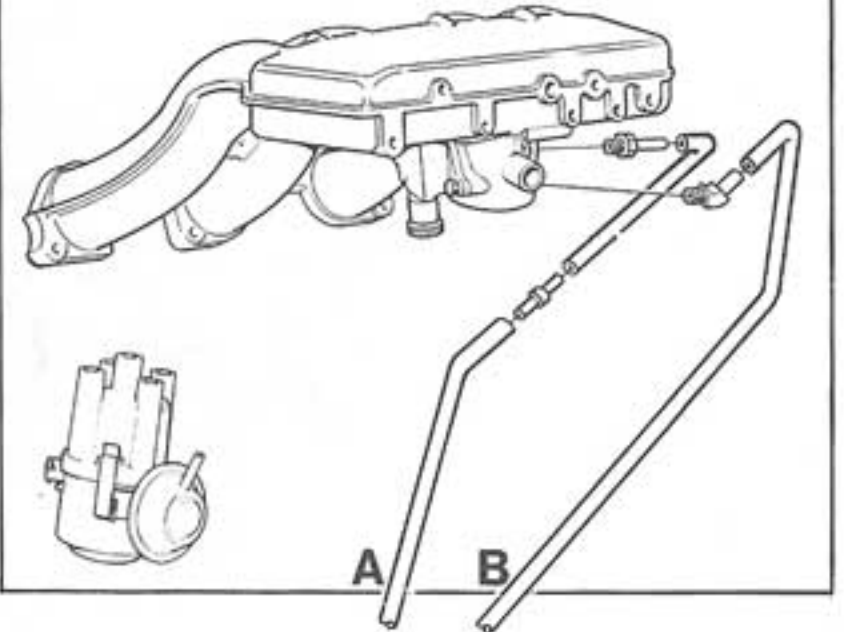
## E/F engines 1980-84

B21F-5 and  
E engines without EGR

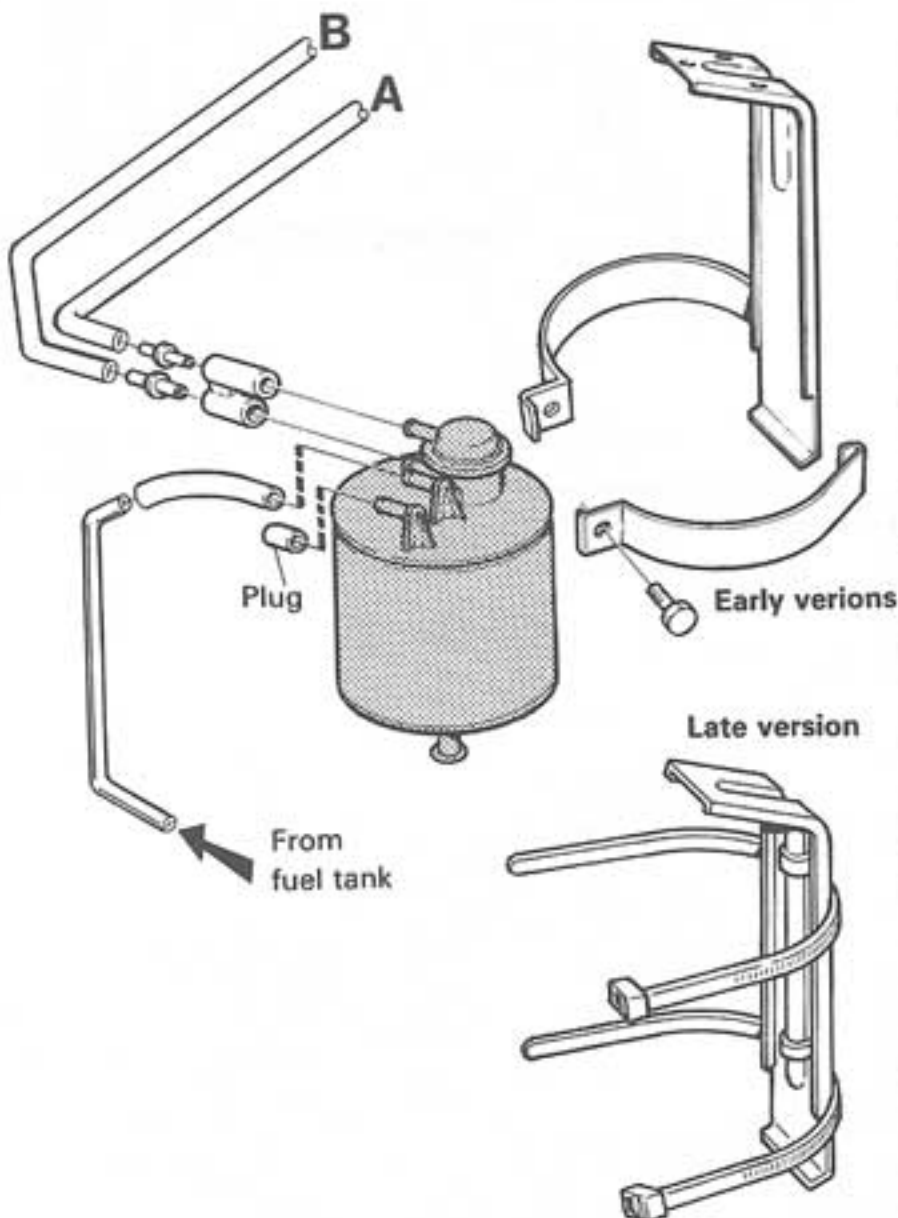
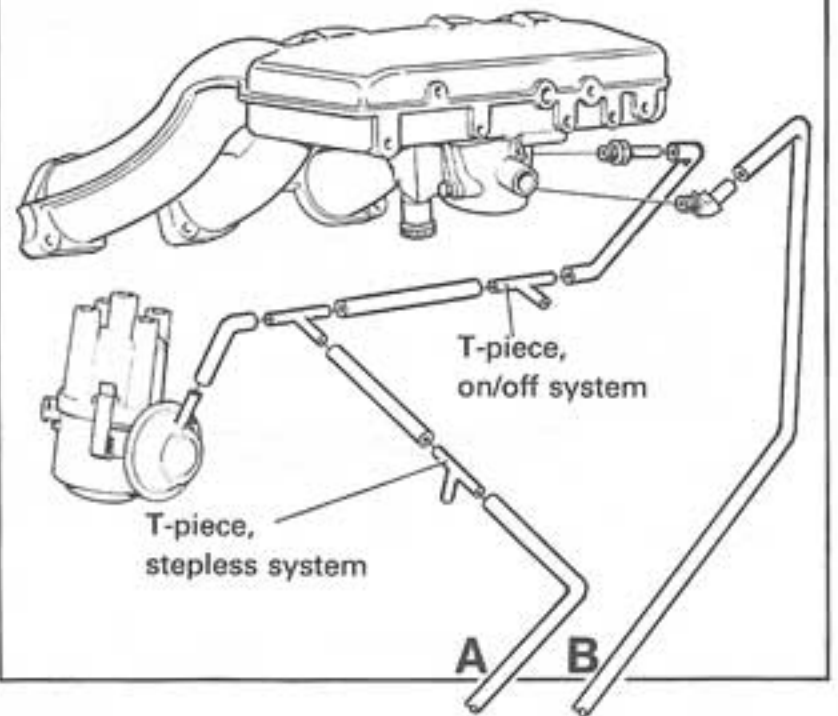
Delay valve, only provided  
on certain variants



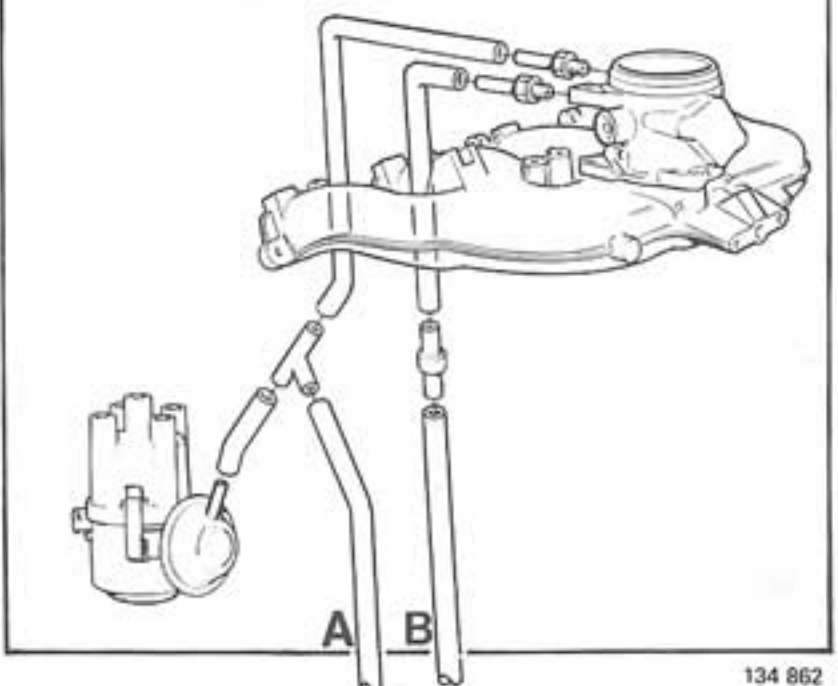
B21F-9



E engines with EGR

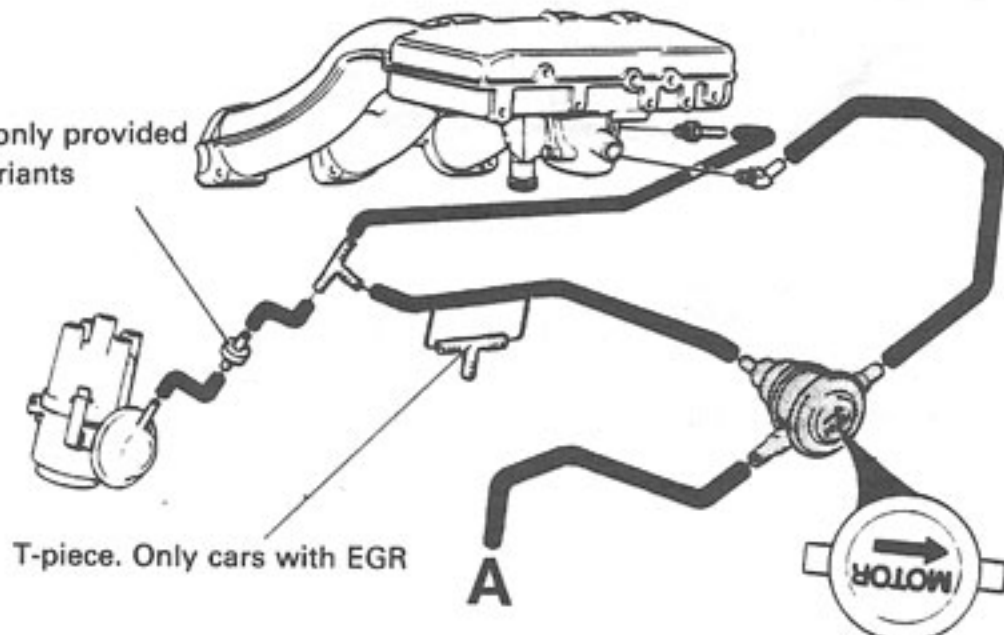


Turbo

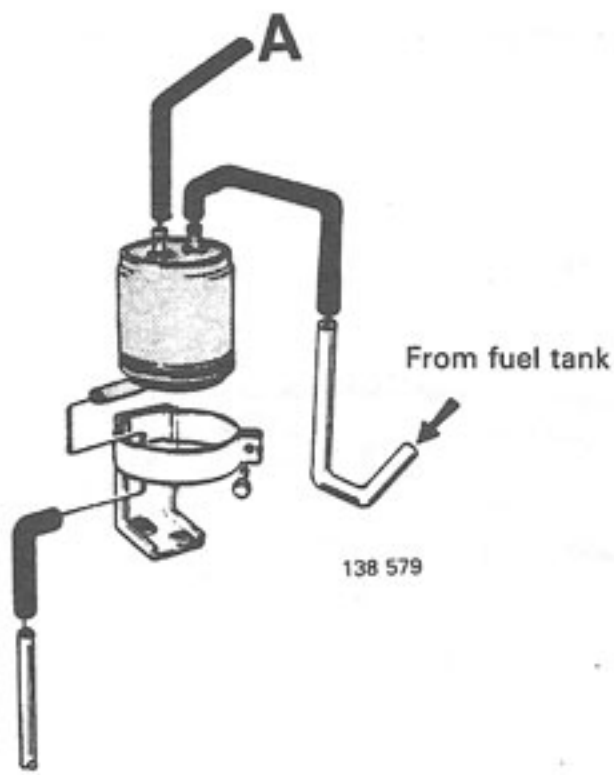


# Connection of carbon filter and EGR valve 1978-79 E/F engines

Delay valve, only provided  
on certain variants



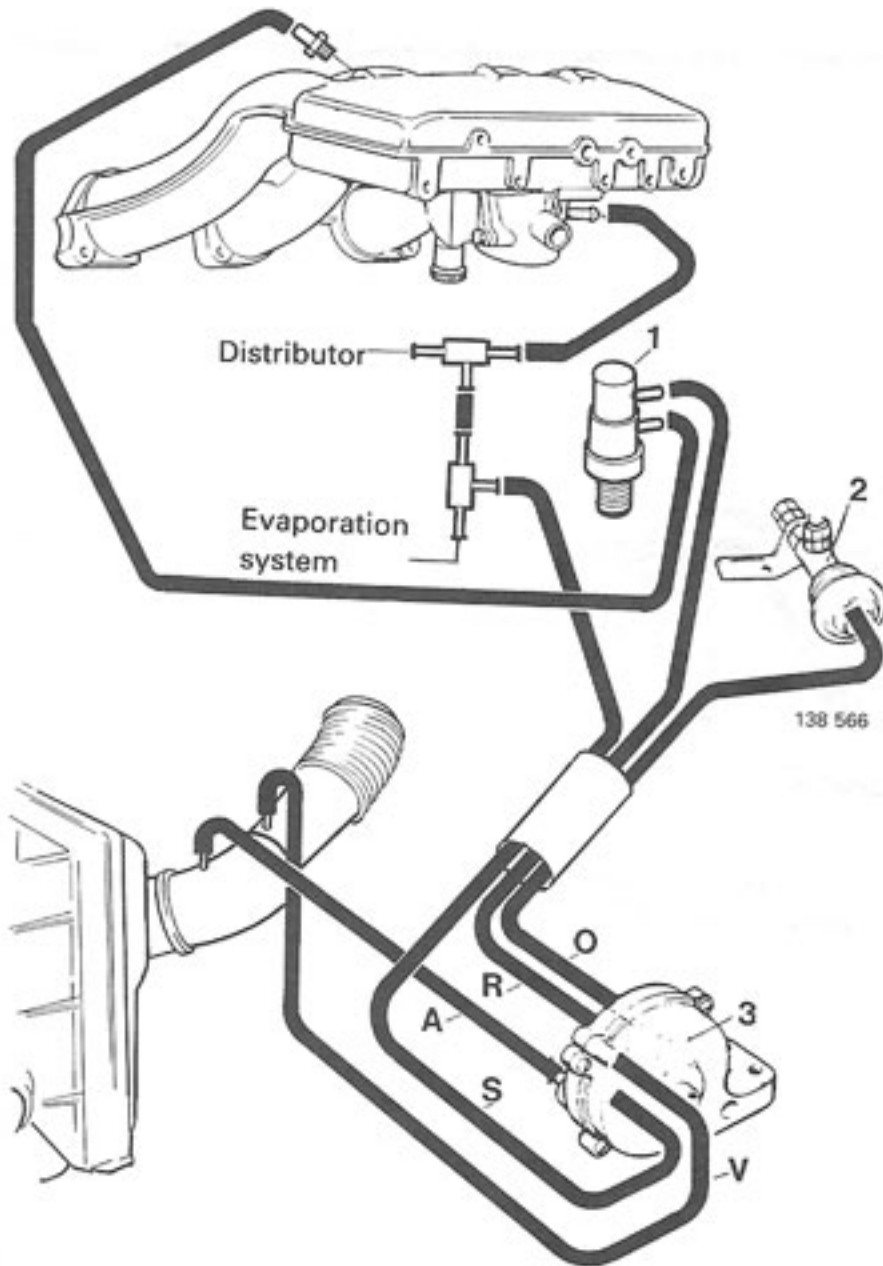
138 578



138 579



## E/F engines 1978-



### Market

USA Federal

Canada

Australia,

Scandinavia

Switzerland

### Model

1978-79

1981-83

1981-84

1983-84

### Type

B 21 F

B 23 E automatic

B 23 E automatic

B 23 E automatic

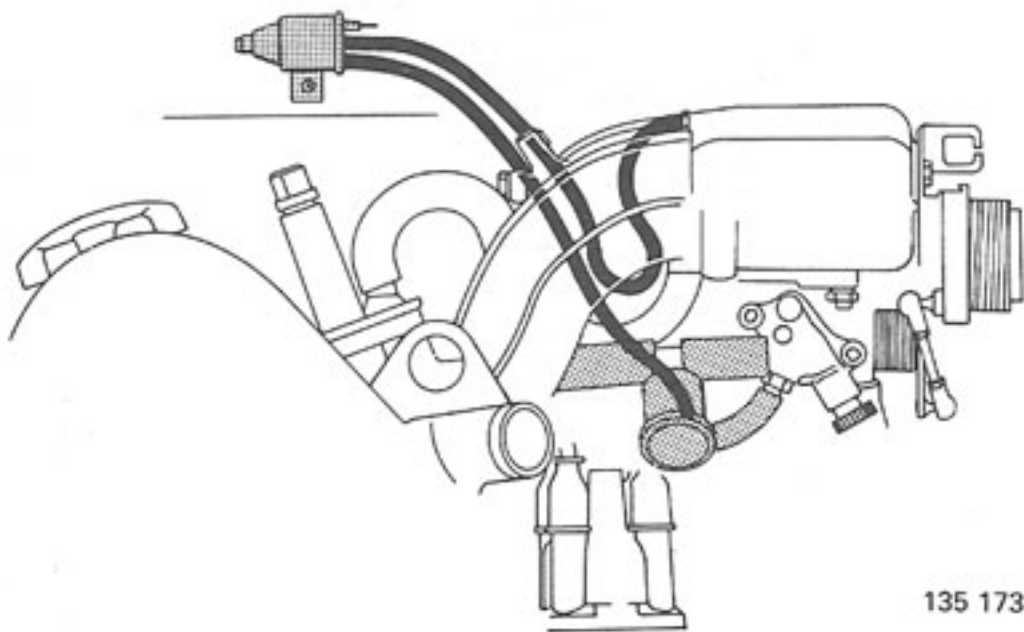
1 Thermostat valve

2 EGR valve

3 Vacuum booster



**E engines 1979–**  
**B21 F      1979–81**

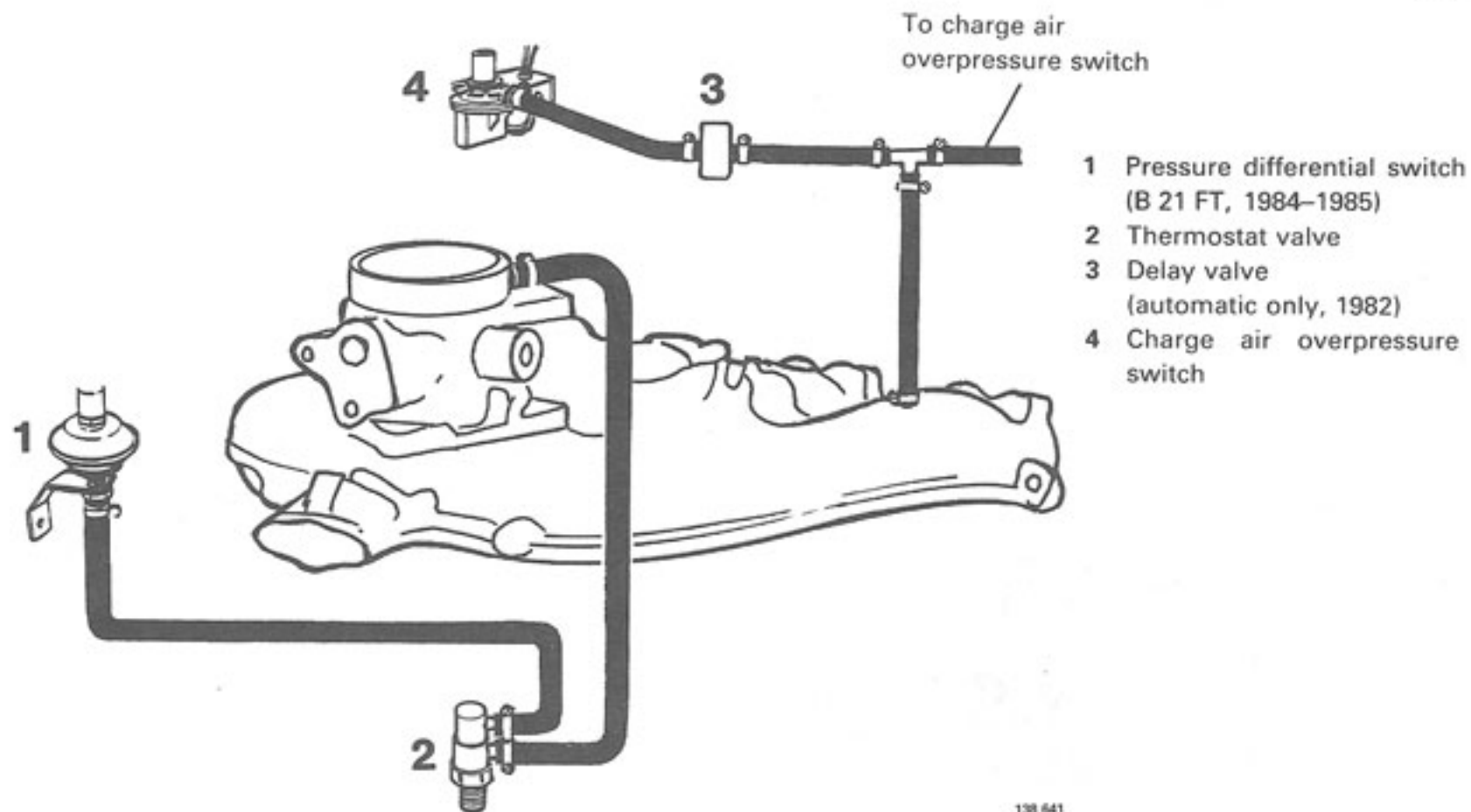


135 173

## Connection of vacuum hoses

For pressure differential switch and charge air pressure switch

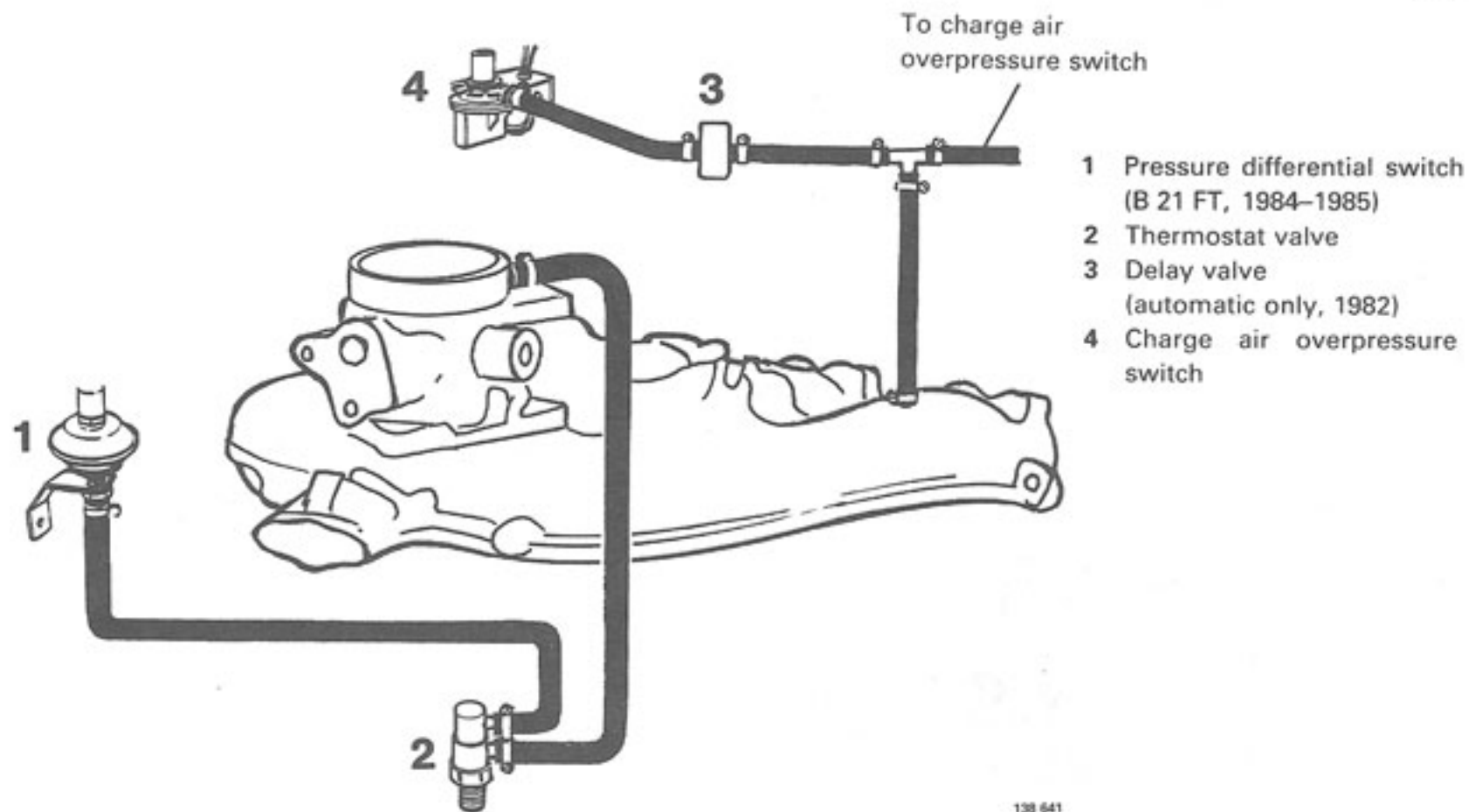
AC2

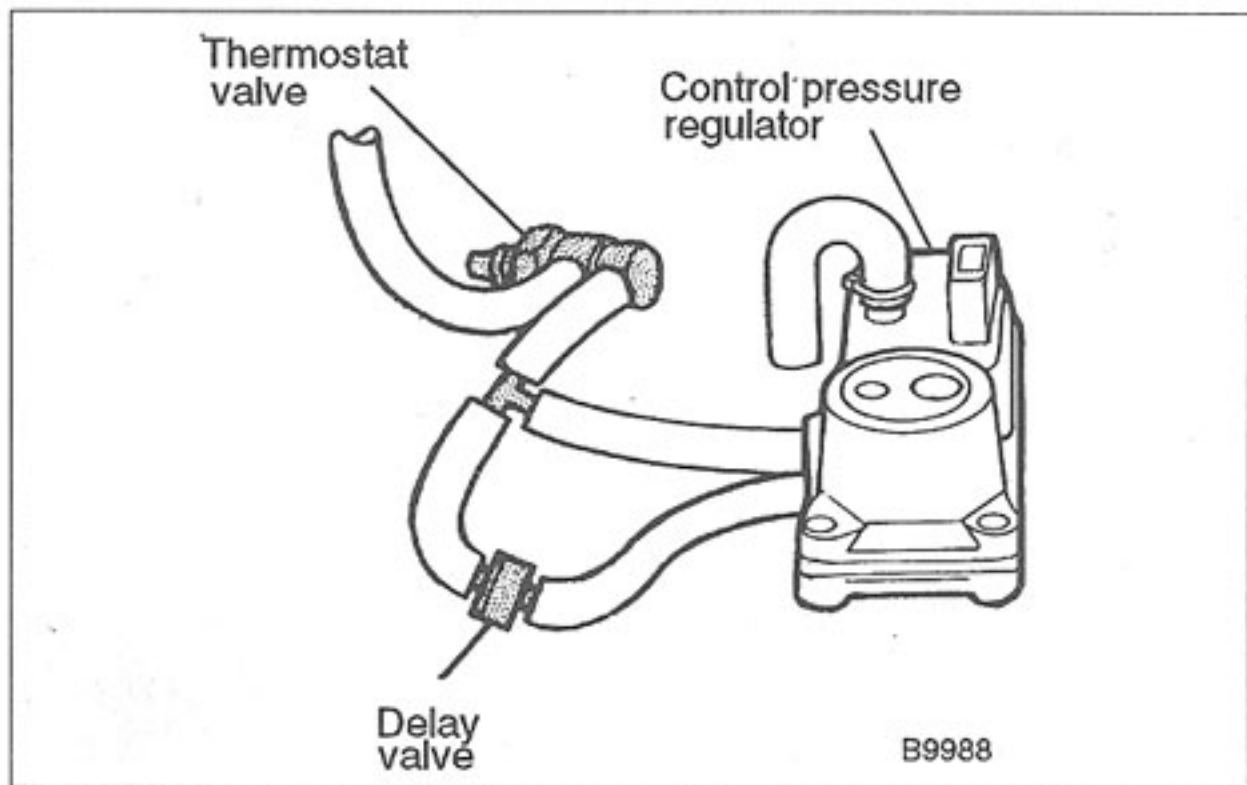


## Connection of vacuum hoses

For pressure differential switch and charge air pressure switch

AC2

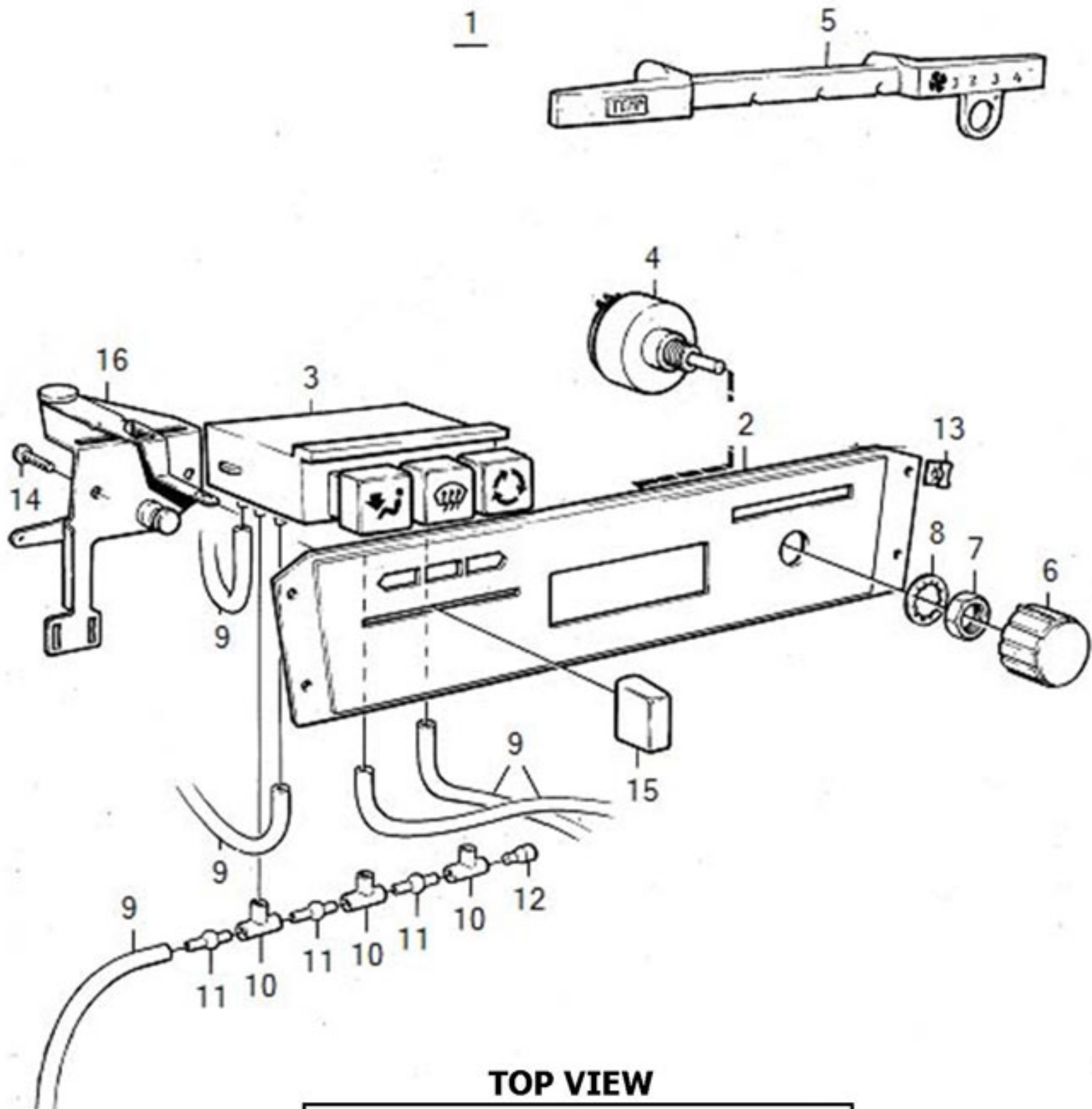




**Fig. 31.** Cold acceleration enrichment system vacuum connections. Colored (gray) side of delay valve should face away from regulator.



# VOLVO 240 VENT CONTROL DIAGRAM



## TOP VIEW

